

H-13 HOTWORK EJECTOR PINS

TIGHTEST TOLERANCE IN THE INDUSTRY (.0003")

TOLERANCES				
D	H	T	L	
UP TO 1/2" DIA. AND UP TO 14" LG.	-.0005" -.0008"	+.000"	+.000"	+.375"
OVER 1/2" DIA. OR OVER 14" LG.	-.0003" -.0008"	-.010"	-.002"	-.000"

HOW TO ORDER: EXAMPLES			
Qty.	Cat No.	(IF .005" O.S.)	Length
25	RX-13	+.005	L-10
50	RX-5		L-10

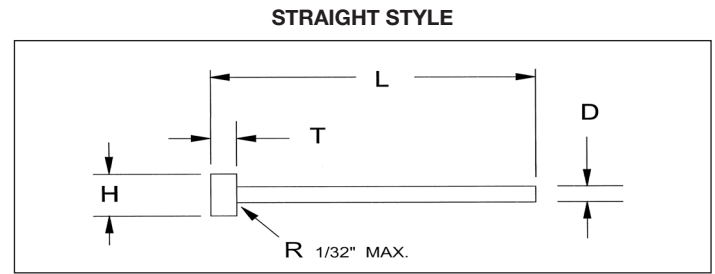

D		H	T	CATALOG NUMBER	L-4"	L-6"	L-10"		L-14"		L-18"		L-25"	L-36"	PKG. QTY.		
PIN DIA.	NOMINAL DIA.	HEAD DIA.	HEAD THICK.		STD DIA.	STD DIA.	STD DIA.	+.005" DIA.	STD DIA.	+.005" DIA.	STD DIA.	+.005" DIA.	STD DIA.	STD DIA.			
1/32	0.0313	1/4	1/8	RX-2	Q	Q	Q	Q	Q	Q	Q	Q	Q	Q	12		
3/64	0.0469			RX-3	3.82	3.87	Q	Q	Q	Q	Q	Q	Q	Q		Q	
1/16	0.0625			RX-5	3.56	3.65	5.17	6.02	Q	Q	Q	Q	Q	Q		Q	
5/64	0.0781			RX-6	3.56	3.65	4.83	6.02	Q	Q	Q	Q	Q	Q		Q	
3/32	0.0938			RX-7	3.20	3.30	3.75	4.75	Q	Q	Q	Q	Q	Q		Q	
7/64	0.1094			RX-8	3.20	3.30	3.75	4.75	Q	Q	Q	Q	Q	Q		Q	
1/8	0.1250			RX-9	1.73	1.79	1.99	2.36	2.61	2.80	6.06	Q	Q	Q		Q	
9/64	0.1406			RX-10	Q	2.19	2.23	2.54	3.04	Q	5.77	Q	Q	Q		Q	
5/32	0.1563			9/32	5/32	RX-11	1.81	1.87	2.09	2.46	2.81	3.10	3.99	Q		Q	Q
11/64	0.1719			11/32	3/16	RX-12	2.18	2.24	2.50	2.89	3.32	Q	Q	Q		Q	Q
3/16	0.1875	3/8	3/16	RX-13	1.90	1.95	2.39	2.69	3.10	3.50	4.28	Q	6.12	Q			
13/64	0.2031			RX-14	Q	Q	2.74	Q	3.52	Q	Q	Q	Q	Q	Q		
7/32	0.2188	13/32	3/16	RX-15	2.13	2.18	2.73	3.06	3.62	Q	Q	Q	6.63	Q			
15/64	0.2344			RX-16	Q	Q	3.00	Q	3.88	Q	Q	Q	Q	Q	Q		
B	0.2380	7/16	3/16	RX-B	Q	Q	4.39	Q	Q	Q	Q	Q	Q	Q			
C	0.2420			RX-C	Q	Q	4.49	Q	Q	Q	Q	Q	Q	Q	Q		
D	0.2460			RX-D	Q	Q	4.59	Q	Q	Q	Q	Q	Q	Q	Q		
1/4	0.2500			RX-17	2.24	2.29	2.98	3.34	3.86	4.27	4.95	5.60	7.13	Q	Q		
F	0.2570			RX-F	Q	Q	4.64	Q	Q	Q	Q	Q	Q	Q	Q		
G	0.2610			RX-G	Q	Q	4.69	Q	Q	Q	Q	Q	Q	Q	Q		
17/64	0.2656	7/16	1/4	RX-18	Q	Q	3.52	Q	4.21	Q	Q	Q	7.55	Q			
I	0.2720			RX-I	Q	Q	4.85	Q	Q	Q	Q	Q	Q	Q	Q		
J	0.2770			RX-J	Q	Q	4.90	Q	Q	Q	Q	Q	Q	Q	Q		
9/32	0.2813			RX-19	2.77	2.87	3.65	3.75	4.35	Q	5.80	Q	8.05	Q	Q		
L	0.2900	1/2	1/4	RX-L	Q	Q	5.20	Q	Q	Q	Q	Q	Q	Q			
M	0.2950			RX-M	Q	Q	5.25	Q	Q	Q	Q	Q	Q	Q	Q		
19/64	0.2969			RX-20	Q	Q	3.86	Q	4.85	Q	Q	Q	Q	Q	Q		
N	0.3020			RX-N	Q	Q	5.36	Q	Q	Q	Q	Q	Q	Q	Q		
5/16	0.3125			RX-21	3.06	3.16	4.06	4.15	4.85	5.40	6.38	6.99	8.66	32.13	Q		
P	0.3230			RX-P	Q	Q	5.66	Q	Q	Q	Q	Q	Q	Q	Q		
21/64	0.3281	9/16	1/4	RX-22	Q	Q	4.35	Q	5.64	Q	Q	Q	9.37	Q			
Q	0.3320			RX-Q	Q	Q	5.87	Q	Q	Q	Q	Q	Q	Q	Q		
R	0.3390			RX-R	Q	Q	5.97	Q	Q	Q	Q	Q	Q	Q	Q		
11/32	0.3438			RX-23	3.51	3.56	4.55	4.70	5.73	Q	Q	Q	9.70	Q	Q		
23/64	0.3594	5/8	1/4	RX-24	Q	Q	4.85	Q	6.13	Q	Q	Q	Q	Q			
U	0.3680			RX-U	Q	Q	6.48	Q	Q	Q	Q	Q	Q	Q	Q		
3/8	0.3750			RX-25	3.71	3.75	5.05	5.24	6.19	6.77	8.35	9.18	11.88	31.61	Q		
V	0.3770			RX-V	Q	Q	6.63	Q	Q	Q	Q	Q	Q	Q	Q		
W	0.3860			RX-W	Q	Q	6.63	Q	Q	Q	Q	Q	Q	Q	Q		
X	0.3970			RX-X	Q	Q	6.99	Q	Q	Q	Q	Q	Q	Q	Q		
Y	0.4040	11/16	1/4	RX-Y	Q	Q	7.14	Q	Q	Q	Q	Q	Q	Q			
13/32	0.4063			RX-27	4.11	4.15	5.63	5.90	7.28	Q	9.60	Q	13.82	Q	Q		
7/16	0.4375			RX-29	4.46	4.55	6.19	6.43	7.87	8.62	10.70	Q	15.45	34.31	Q		
15/32	0.4688			RX-31	5.73	5.83	6.78	7.02	11.29	Q	11.82	Q	17.58	Q	Q		
1/2	0.5000	3/4	1/4	RX-33	5.29	5.44	7.37	7.71	9.69	10.29	12.80	Q	19.02	37.98	6		
9/16	0.5625	13/16	1/4	RX-35	Q	6.72	9.17	Q	11.68	Q	15.25	Q	21.82	Q			
5/8	0.6250	7/8	1/4	RX-37	Q	7.79	10.76	Q	13.56	Q	17.60	Q	24.63	Q			
11/16	0.6875	15/16	1/4	RX-39	Q	10.26	12.69	Q	17.89	Q	25.76	Q	28.75	Q			
3/4	0.7500	1	1/4	RX-41	Q	10.86	14.58	Q	18.55	Q	26.76	Q	32.69	Q			
7/8	0.8750	1-1/8	1/4	RX-45	Q	23.30	27.40	Q	46.55	Q	65.75	Q	84.85	Q		4	
1	1.0000	1-1/4	1/4	RX-47	Q	24.40	27.40	Q	53.95	Q	69.80	Q	90.35	Q	2		

Q=Price Per Quotation

← See previous page for Custom Modification information and Quantity Discounts.